



### PRODUCT FEATURES

- Hinged rear door
- Solid glass front
- Single glazed
- Three adjustable shelves
- Ticket strips on shelves and deck
- Under shelf and canopy LED lights
- Ambient converted from heated
- Air removal fan installed in ceiling

### CABINET DIMENSIONS & SPECIFICATIONS

Ambient

Model	Cabinet			Shelving no.	Display m2	Total food units	Operating Current	Connection	Voltage
	Length mm	Depth mm	Height mm						
STGAB6	600	650	920	3 + base	0.80	55	0.2 Amp	10amp 3 pin plug	240V

\* prior to installation see, installation guidelines, ventilation requirements and drainage options documents

### ELECTRICAL POWER

Electrical power cord 2200mm  
3 pin 10 amp 1 phase socket required.

Maximum shelf load weight 15kg  
spread evenly

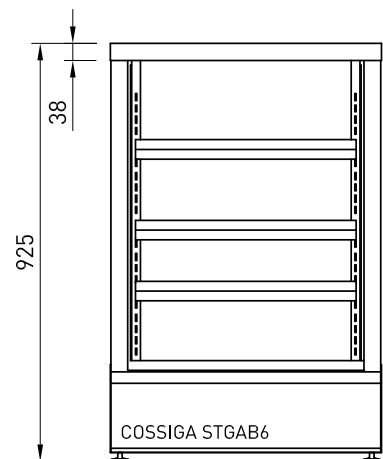
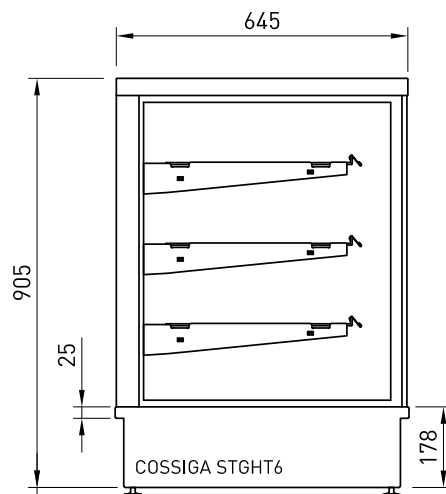
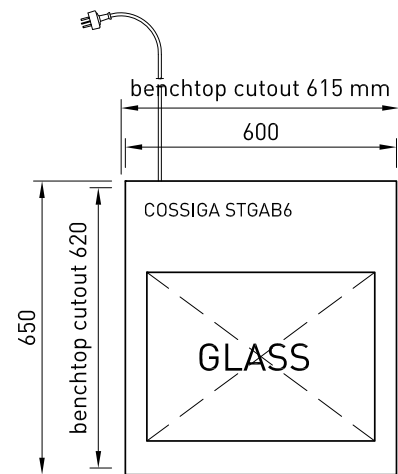



### PRODUCT FEATURES

- Sliding rear doors
- Solid glass front
- Single glazed
- Three adjustable shelves
- Ticket strips on shelves and deck
- Under shelf and canopy LED lights
- Ambient converted from heated
- Air removal fan installed in ceiling

### CABINET DIMENSIONS & SPECIFICATIONS

Ambient

Model	Cabinet			Shelving no.	Display m2	Total food units	Operating Current	Connection	Voltage
	Length mm	Depth mm	Height mm						
STGAB9	900	650	920	3 + base	1.27	84	0.3 Amp	10amp 3 pin plug	240V

\* prior to installation see, installation guidelines, ventilation requirements and drainage options documents

### ELECTRICAL POWER

Electrical power cord 2200mm  
3 pin 10 amp 1 phase socket required.

Maximum shelf load weight 15kg  
spread evenly

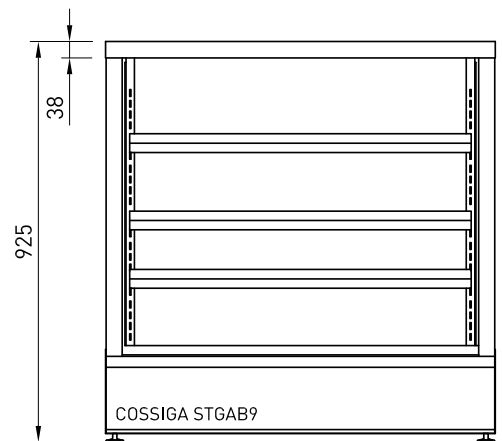
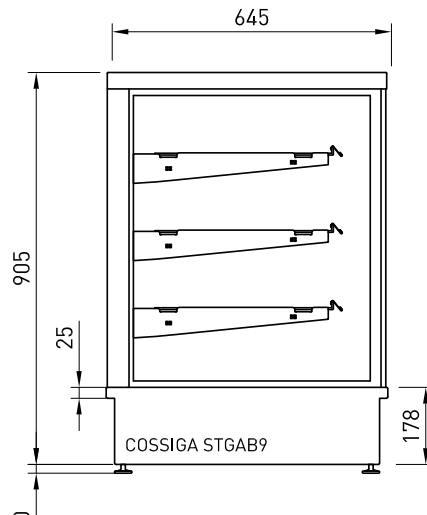
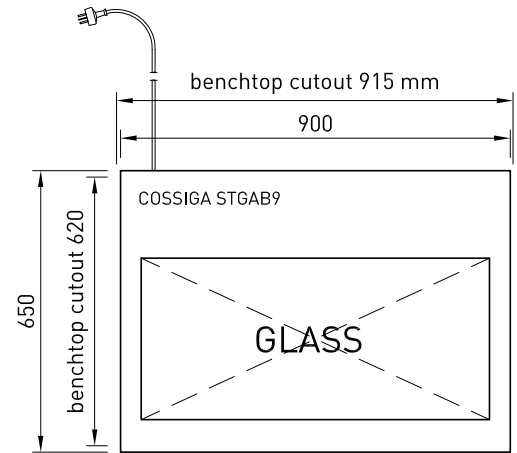



### PRODUCT FEATURES

- Sliding rear doors
- Solid glass front
- Single glazed
- Three adjustable shelves
- Ticket strips on shelves and deck
- Under shelf and canopy LED lights
- Ambient converted from heated
- Air removal fan installed in ceiling

### CABINET DIMENSIONS & SPECIFICATIONS

Ambient

Model	Cabinet			Shelving no.	Display m2	Total food units	Operating Current	Connection	Voltage
	Length mm	Depth mm	Height mm						
STGAB12	1200	650	920	3 + base	1.75	121	0.4 Amp	10amp 3 pin plug	240V

\* prior to installation see, installation guidelines, ventilation requirements and drainage options documents

### ELECTRICAL POWER

Electrical power cord 2200mm  
3 pin 10 amp 1 phase socket required.

Maximum shelf load weight 15kg  
spread evenly

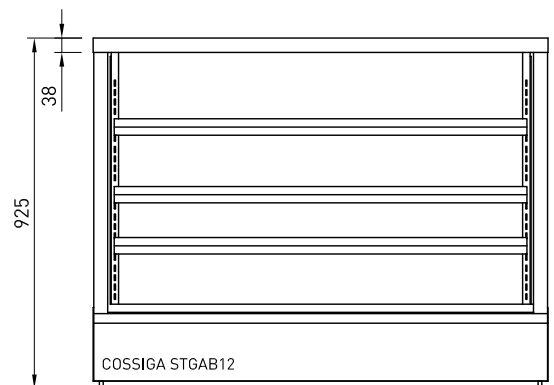
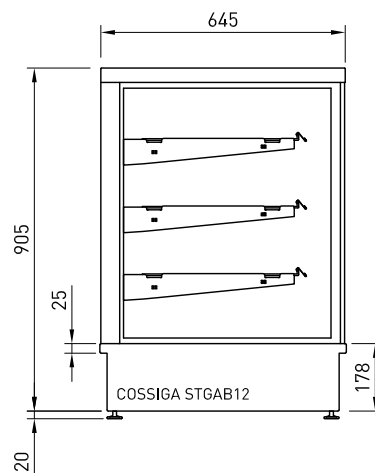
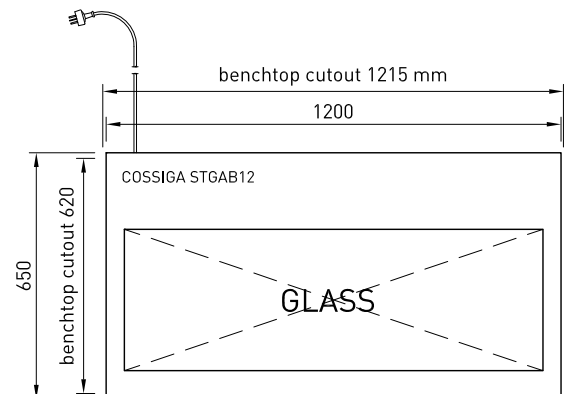



### PRODUCT FEATURES

- Sliding front doors, hinged rear door
- Single glazed
- Three adjustable shelves
- Ticket strips on shelves and deck
- Under shelf and canopy LED lights
- Solid glass front - optional
- Ambient converted from heated
- Air removal fan installed in ceiling

### CABINET DIMENSIONS & SPECIFICATIONS

Ambient

Model	Cabinet			Shelving no.	Display m2	Total food units	Operating Current	Connection	Voltage
	Length mm	Depth mm	Height mm						
STGAB6-SD	600	650	920	3 + base	0.80	55	0.2 Amp	10amp 3 pin plug	240V

\* prior to installation see, installation guidelines, ventilation requirements and drainage options documents

### ELECTRICAL POWER

Electrical power cord 2200mm  
3 pin 10 amp 1 phase socket required.

Maximum shelf load weight 15kg  
spread evenly

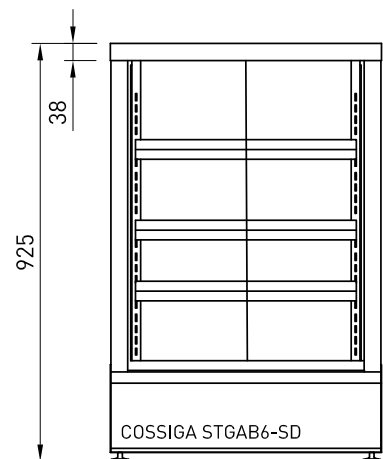
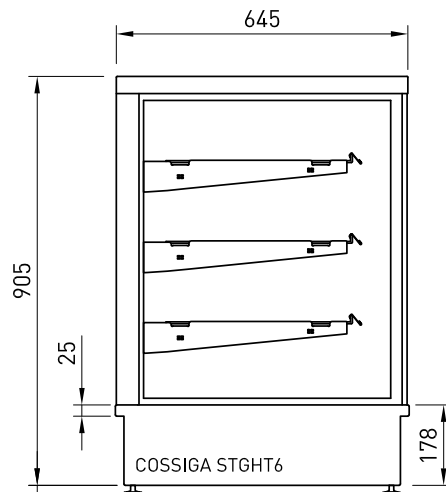
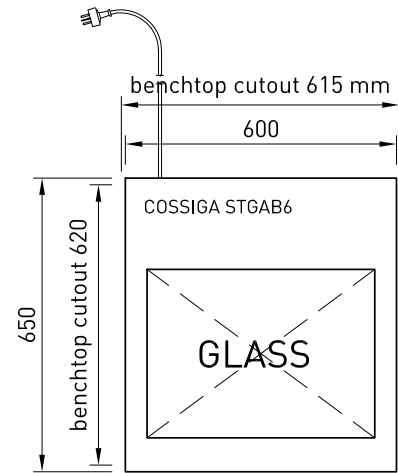



### PRODUCT FEATURES

- Sliding doors front and rear
- Single glazed
- Three adjustable shelves
- Ticket strips on shelves and deck
- Under shelf and canopy LED lights
- Solid glass front - optional
- Ambient converted from heated
- Air removal fan installed in ceiling

### CABINET DIMENSIONS & SPECIFICATIONS

Ambient

Model	Cabinet			Shelving no.	Display m2	Total food units	Operating Current	Connection	Voltage
	Length mm	Depth mm	Height mm						
STGAB9-SD	900	650	920	3 + base	1.27	84	0.3 Amp	10amp 3 pin plug	240V

\* prior to installation see, installation guidelines, ventilation requirements and drainage options documents

### ELECTRICAL POWER

Electrical power cord 2200mm  
3 pin 10 amp 1 phase socket required.

Maximum shelf load weight 15kg  
spread evenly

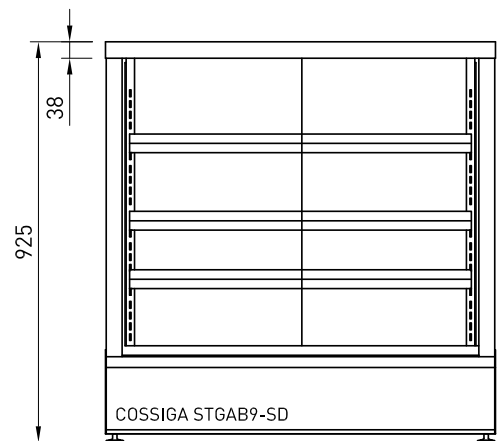
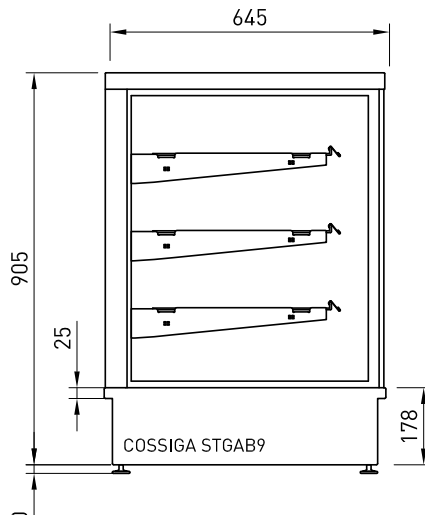
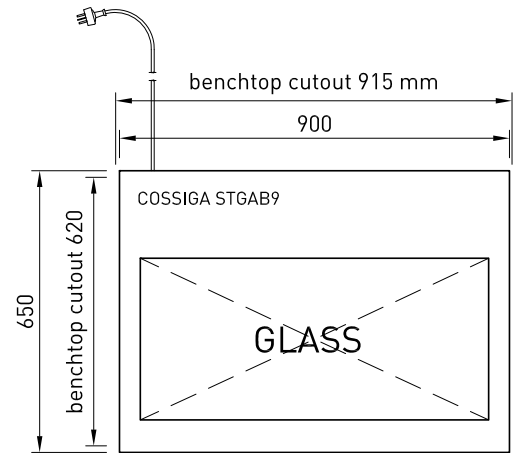



### PRODUCT FEATURES

- Sliding doors front and rear
- Single glazed
- Three adjustable shelves
- Ticket strips on shelves and deck
- Under shelf and canopy LED lights
- Solid glass front - optional
- Ambient converted from heated
- Air removal fan installed in ceiling

### CABINET DIMENSIONS & SPECIFICATIONS

Ambient

Model	Cabinet			Shelving no.	Display m2	Total food units	Operating Current	Connection	Voltage
	Length mm	Depth mm	Height mm						
STGAB12-SD	1200	650	920	3 + base	1.75	121	0.4 Amp	10amp 3 pin plug	240V

\* prior to installation see, installation guidelines, ventilation requirements and drainage options documents

### ELECTRICAL POWER

Electrical power cord 2200mm  
3 pin 10 amp 1 phase socket required.

Maximum shelf load weight 15kg  
spread evenly

